



KAHLES

QUICK REFERENCE GUIDE

HELIA RF-M



20020 HELIA RF-M 7x25

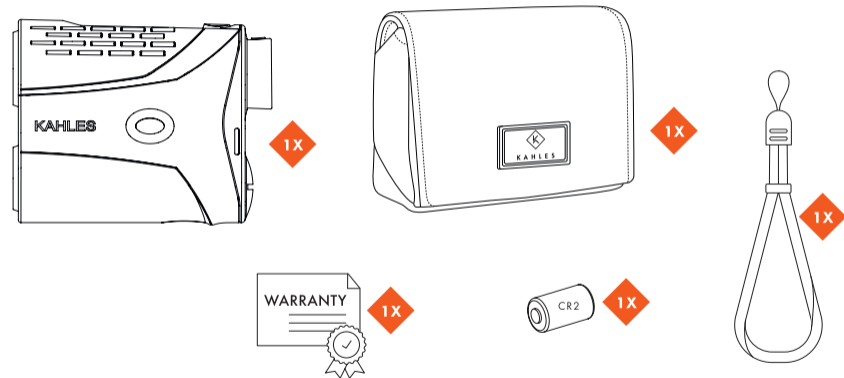

SWITCH ON / STATIC MODE

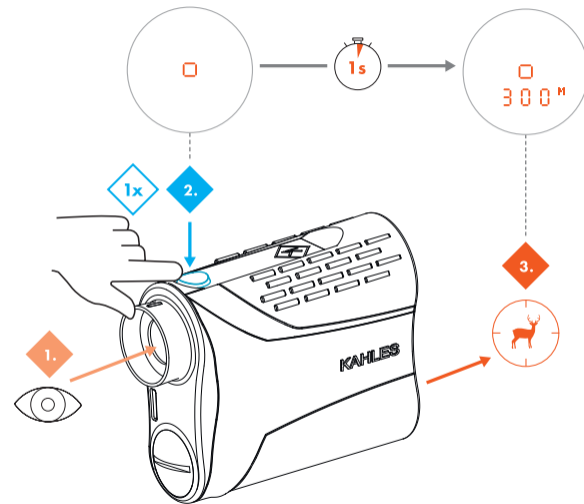

SWITCH OFF / ERROR

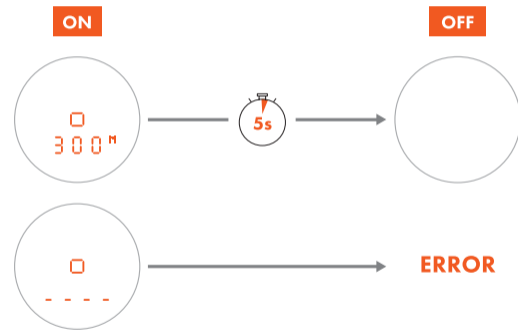

SCAN MODE

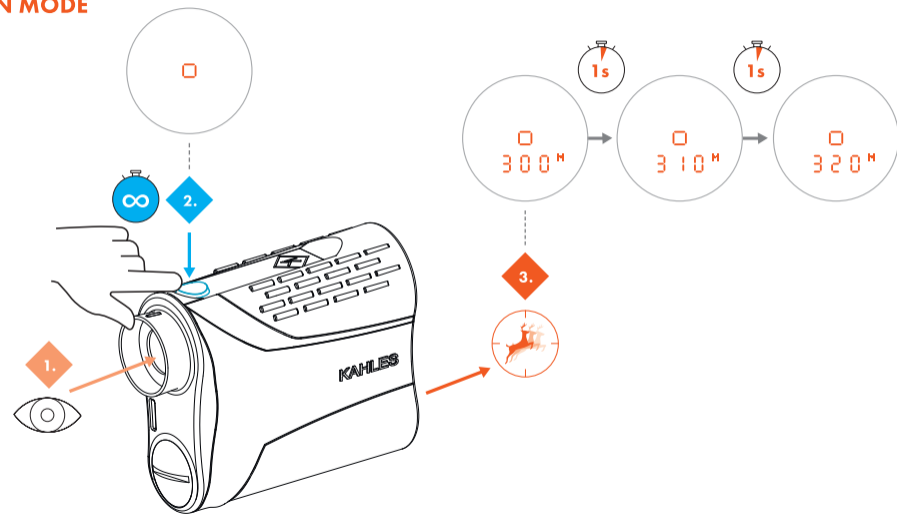

DISPLAY BRIGHTNESS

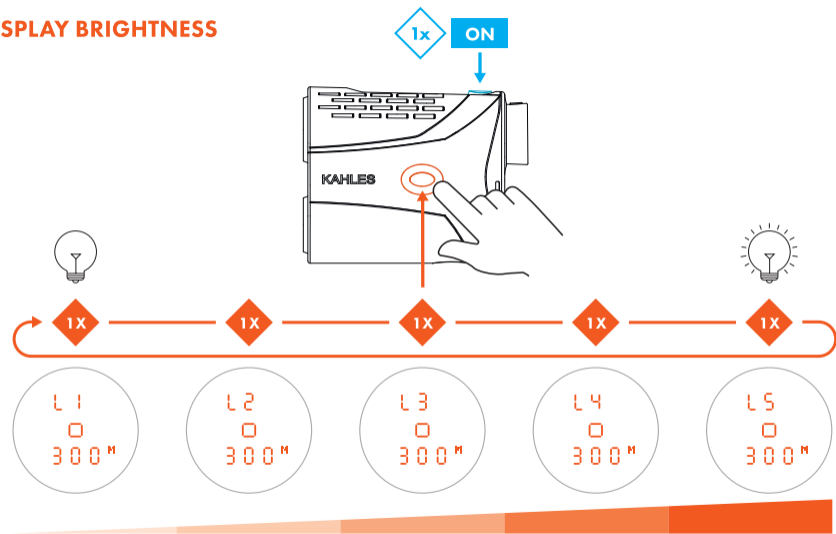

TEMPERATURE / AIR PRESSURE

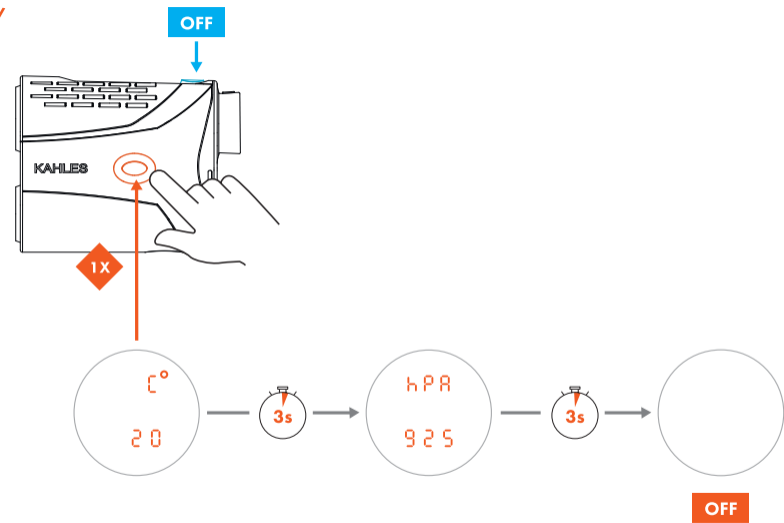

DIOPTER

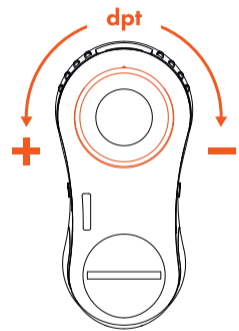

MAX +/-4

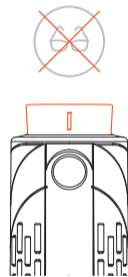

A

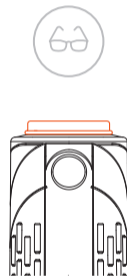

B

HAND STRAP

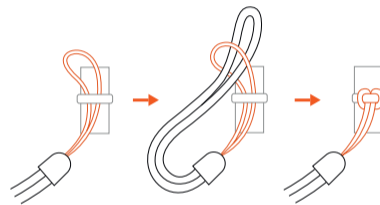
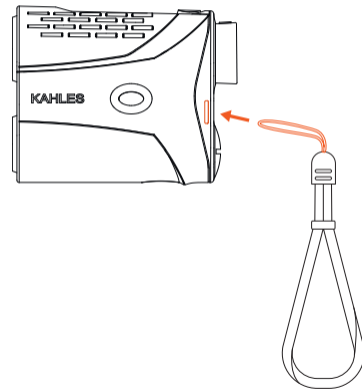

MENU

OFF

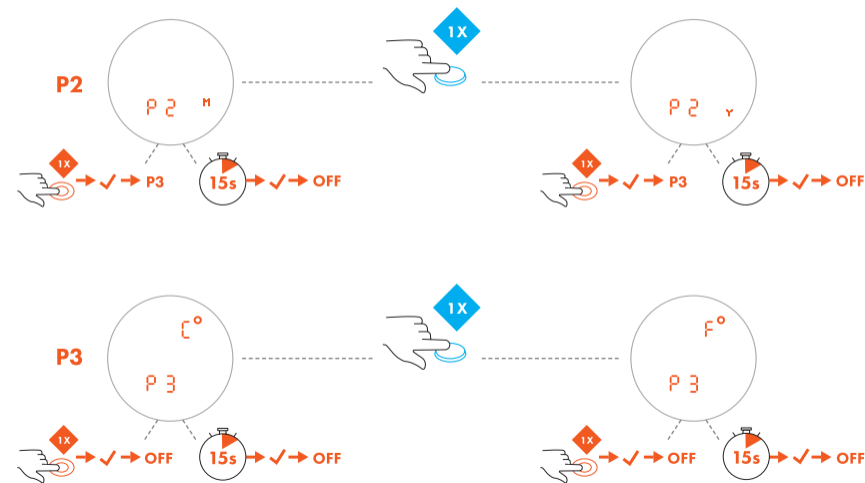
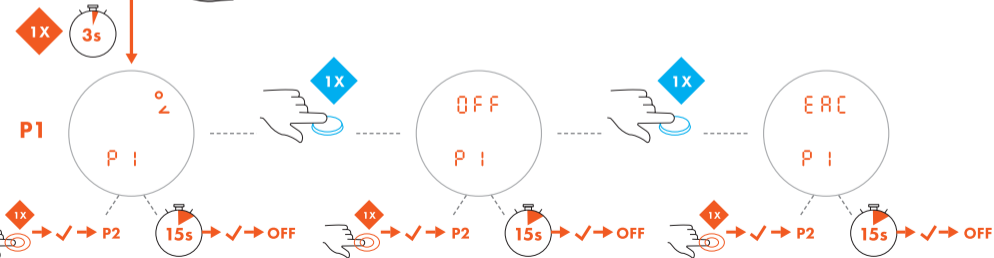
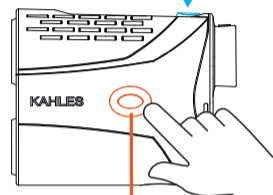

EAC – ENHANCED ANGLE COMPENSATION

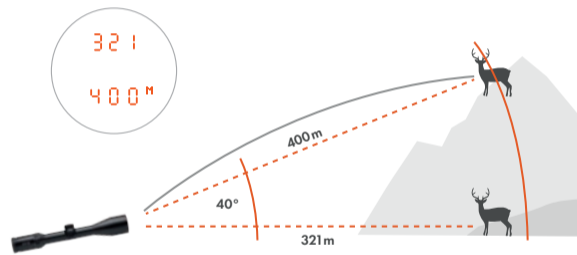

LOW BATTERY

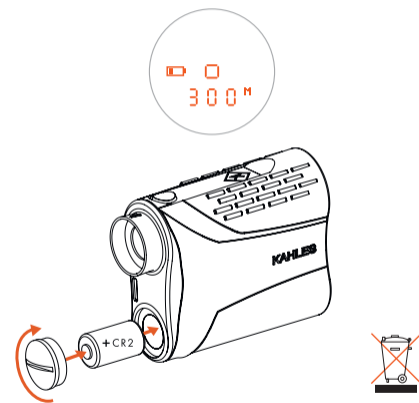

RANGE HIGHER



COLOR



SURFACE



ANGLE



SIZE



SUNLIGHT



ATMOSPHERE



STRUCTURE



RANGE LOWER



NOTES

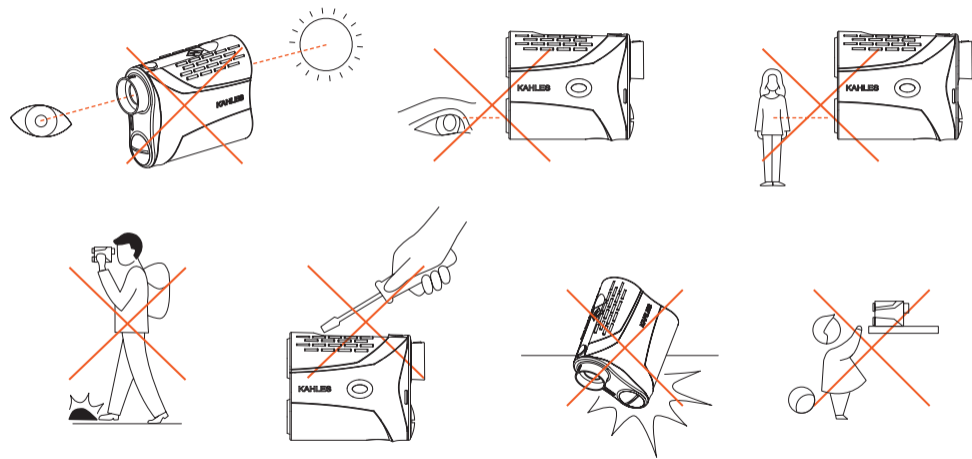

NOTES



kahles.at/en/service



FC

CE



CLASS 1M LASER

Do not view directly with
optical instruments

IEC 60825-1:2014

FDA CFR 1040.10 & 1040.11



kahles.at

KAHLES Gesellschaft m.b.H. | Danfoss-Straße 5 | 2353 Guntramsdorf | Austria
T: +43/2236/520 20/0 | info@kahles.at